



ROOTS Meters & Instruments

DATA SHEET

G100 (1M³) Secondary Meter

Temperature Range	deg.C	-40 to +60
Base Rating (Qmax)	m ³ /h	160
Max. Operating Pressure	bar	16
Leak Test (1.1 x MOP)	bar	17.6
Static Test (1.5 x MOP)	bar	24
Rangeability +/- 1%	ratio	120:1
Rangeability +/- 2%	ratio	160:1
Start Rate	m ³ /h	0.0340
Stop Rate	m ³ /h	0.0230
Flow Rate @ 1.25mbar	m ³ /h	130
Avg. Differential, 100% Flow	mbar	1.45
Max. Pressurisation Rate	kPa/sec	35
Max. Operating Speed	rpm	1667
Gear Ratio	ratio	952.32
Displaced Volume/Revolution	dm ³	1.05
Drive Rate	m ³ /rev	1.0
Min. Odometer Reading	m ³ /h	0.02
Odometer Turnover	yrs	7.13
Nominal Pipe Size	mm	80
Flange to Flange	mm	171
Flange Connection	DIN	DN80 PN16
Bolts per Flange	Qty	8
Bolt Size	mm	M16 x 40
Flange Bolt Hole Depth	mm	24
Bolt Torque: Lubricated/Non-Lub.	N-m	74/81
Oil Capacity (Side Inlet)	ml	47
Oil Capacity (Top Inlet)	ml	225

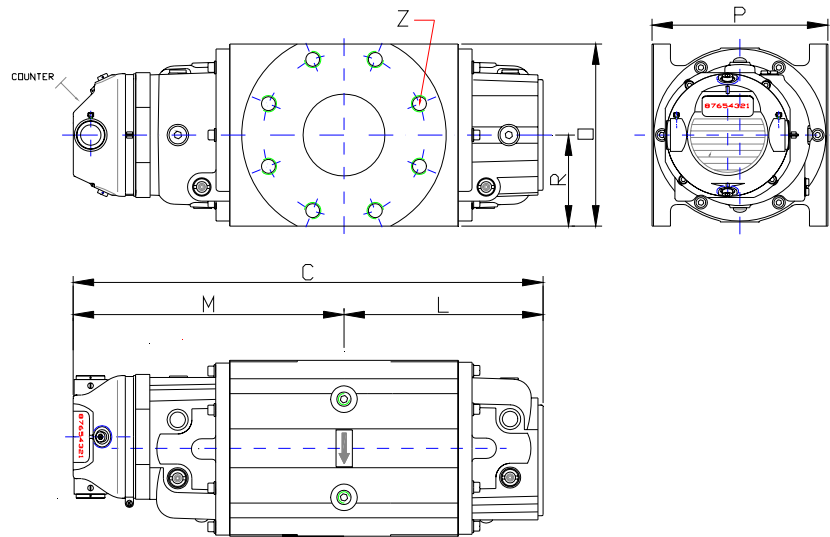
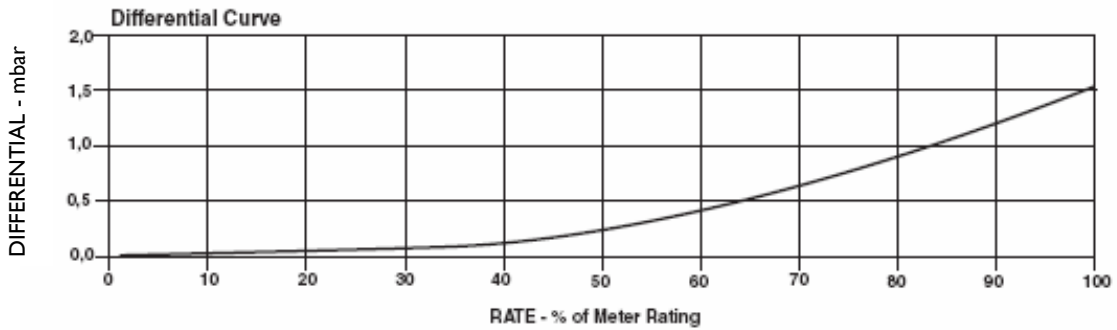
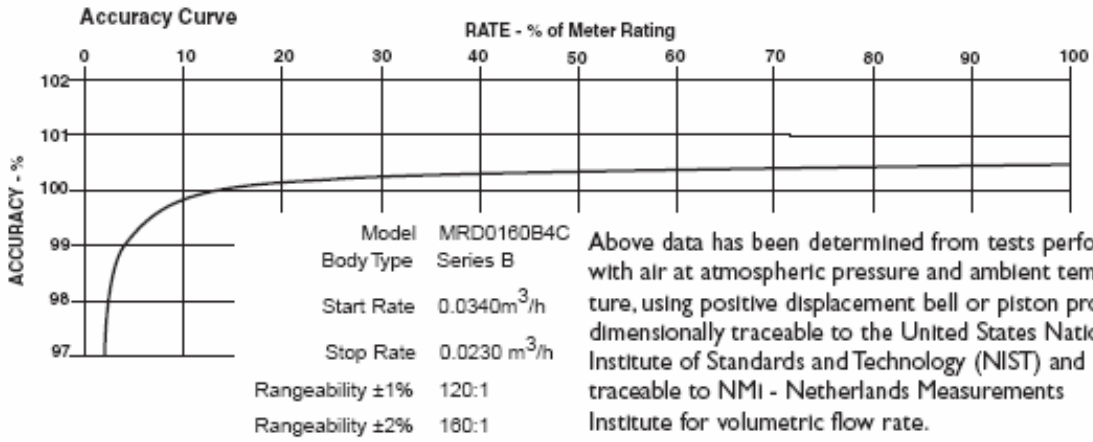

Meter Size	C mm	L mm	M mm	O mm	P mm	R mm	Z	Flange	Weight Kg
5MT	460	195	265	177	171	89	8	DN80	17



**Roots Meters
& Instruments**

DMD-ROOTS

DI UK Limited
Dresser Inc